

Level controller with stop valve VAFLO



- Self-sufficient system
- Level controller
- Adjustable height
- Float in Polyester or in PPH

AUTOMATIC LEVEL CONTROLLER WITH FLOAT VALVE

Designed for chemical industry, this valve regulates a fluid level automatically, without external power supply.
All components are made of materials, well-known for chemical compatibilities.
The height adjustment is possible along 120 mm for adjustment when mounting the system.

PRINCIPLE

The float rising with the fluid level, closes the inlet until the flow stops.

TECHNICAL FEATURES

Adjustment along 120 mm
Standard flow rate: 1800 l/h with 1 bar – Pressure limit: 6 bar
On request Q=3600 l/h with 1 bar – Pressure limit: 4 bar

FITTINGS

BSP 1/2" (male)
Flange ND 15 mm / PN 10 bar (flat seal)

Fitting and valve are of the same material.

CODE NUMBERS AND REFERENCES

Code	Reference	Float	Guiding rod	Body	Seal	Fitting
527 015	VAFLO 15	Polyester	AISI 316 L	Hostaform	NBR	1/2" MG
527 020	VAFLO 20	PPH	Hastelloy B2	PPH	FPM	1/2" MG
527 025	VAFLO 25	PPH	Hastelloy B2	PPH	FPM	Flange DN 15

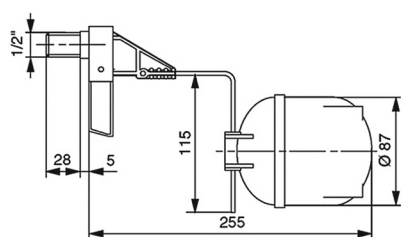

VAFLO 15

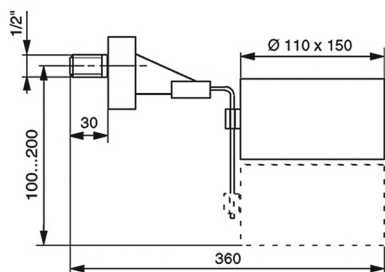

VAFLO 20

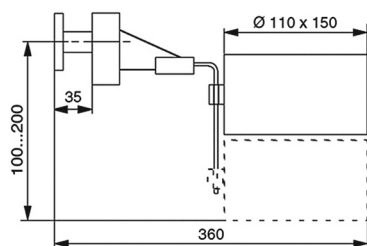

VAFLO 25

BAMO INTERNATIONAL

22, Rue de la Voie des Bans · Z.I. de la gare · 95100 ARGENTEUIL

Tel +33 (0)1 30 25 83 20 Web www.bamo.eu

Fax +33 (0)1 34 10 16 05 E-mail export@bamo.fr

Level controller with stop
valve
VAFLO

12-07-2018

D-527.01-EN-AB

NIV

527-01 /1