

Thermowells TW



- Machined integral or welded
- Large choice of materials
- Process connections:
Process: 1/2", 3/4", 1"
Welded fittings
Flanges

APPLICATIONS

The thermowell is a tubular thermal conductor designed for the insertion of a temperature sensor or a thermometer in a pipe or in a tank. It is recommended for the mechanical protection of a sensor against corrosive effects of fluids in process. It allows to replace an instrument for maintenance, calibration routines, without shutdown of the process.

DESCRIPTION

Thermowells TW are designed to withstand high temperatures and pressures with high speed flows.

According to operating conditions (pressure, temperature, flow, vibrations, corrosion) several models are available:

- Machined integral body or welded body
- Threaded fittings
- Fittings for welding to pipe
- Flanged fittings

MATERIALS

Standard:	AISI 316 L / 316-Ti / 304 / 321
Specific:	Monel / Titanium / Nickel / Hastelloy C276 / Hastelloy C4 / Inconel 600 / Incoloy 800 / etc.
With coating	Tantalum / PTFE / Hastelloy C276 / Hastelloy C4 / Zirconium (wet parts coated)

EC Conformity The instrument meets the legal requirements of the current European Directives.

SPECIFICATIONS

Each TW is identified with:

- Serial N° on request
- Material and immersion depth
- Flange type & PN

DOCUMENTS, CERTIFICATES

- Drawing
- Hydrostatic pressure test
- Control through penetrant inspection
- Certificate within directives EN10204 3.1.B., 3.1.C.
- Casting number stamped on the body and on the flange
- Certificate within directive NACE MR.01.75
- Rupture test, impact test
- Certificate of thermal treatment
- Test HUEY / ASTM A 262-C
- Performance test ASME PTC 19.3 - 1974
- Specification of the welding procedure (W.P.S.)
- Registration of the qualification procedure (P.Q.R.)

BAMO INTERNATIONAL

22, Rue de la Voie des Bans · Z.I. de la gare · 95100 ARGENTEUIL

Tel +33 (0)1 30 25 83 20 Web www.bamo.eu

Fax +33 (0)1 34 10 16 05 E-mail export@bamo.fr

Thermowells
TW

15-11-2019

D-635.02-EN-AA

TE

635-02 /1

OPTIONS

- Shutter and chain
- Polished stem
- Degreasing for use in oxygen
- Extensions

SPECIFICATIONS TO PROVIDE FOR A QUOTE

- Material
- Type and fitting
- Bore diameter and O.D.
- Shape: tapered rod, straight, with elbow, etc.
- Extension, with thermal insulation
- Depth length, total length
- Fittings: to process, for temperature sensor, options.

DIMENSIONS

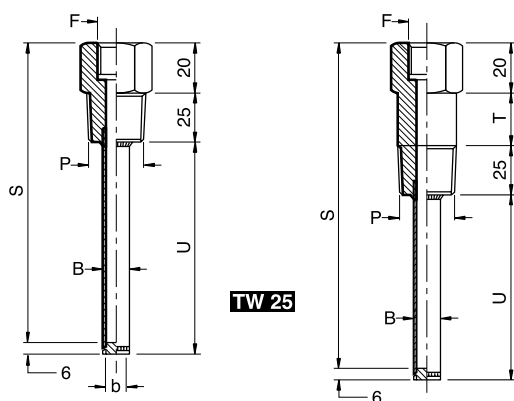

TW 25

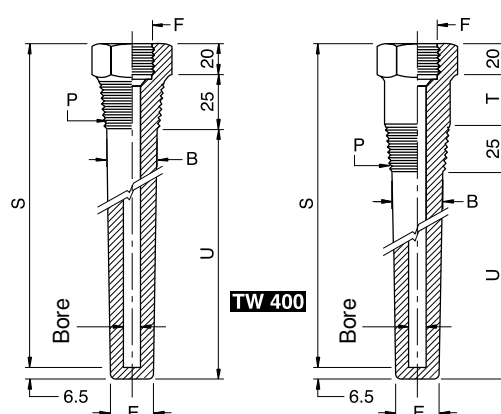

TW 400

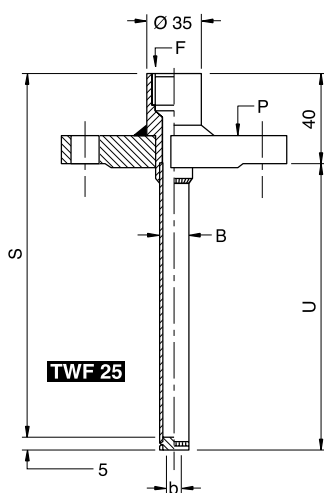

TWF 25

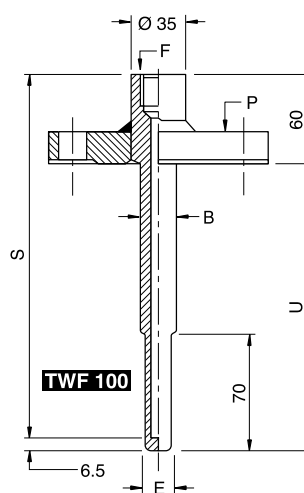

TWF 100

TW 25		
Process P	Stem bx B	Wrench
1/2" NPT	7x12	27
	10x12	
3/4" NPT	7x12	36
	10x12	
1" NPT	7x12	36
	10x12	

TW 400				
Process P	Bore bx B	Ø B	Ø E	Wrench
3/4" NPT	6.35	22	16	27
	9.6		19	
1" NPT	6.35	27	16	36
	9.6		19	

TWF 25 - TWF 100	
Flange	PN
1"	150 to 900 Lbs
1 1/2"	
2"	

BAMO INTERNATIONAL

22, Rue de la Voie des Bans · Z.I. de la gare · 95100 ARGENTEUIL

Tel +33 (0)1 30 25 83 20 Web www.bamo.eu

Fax +33 (0)1 34 10 16 05 E-mail export@bamo.fr

**Thermowells
TW**

15-11-2019

D-635.02-EN-AA

TE

635-02/2