

PRESSURE RELIEF VALVES

SDD 912



- All wetted parts in plastic
- Protection of pumps and process lines
- Affordable cost
- Small dimensions
- Adjustable from 1 to 10 bar
- Nominal diameters from ND 32 to ND 80

APPLICATION AND FITTING

Pressure relief valves SDD 912 limits the static pressure to a constant and maximal settled value by opening the outlet (*to the discharge line*) when the pressure is overriding. The right angle concept allows small dimensions with a reduced weight for easiest fitting on line than any conventional in-line straight pressure relief valve. All wetted parts are in plastics; without any metallic parts exposed to the atmosphere it allows a location in corroding vapours.

The SDD 912 valves may be used as pressure relief valves on volumetric pumping system. These equipment protection devices may be fitted in any position, in line, or on by-pass according to the application.

TECHNICAL FEATURES

Body:	PVC
Seat seal and O-rings:	EPDM (ND 32 to ND 80) or FPM (ND 32 to ND 50)
Relief pressure:	1 to 10 bar
Pressure class:	PN 10 (at 20°C) ; [bar]
Temperature limits:	+10 ... +50°C
Inlet / outlet size:	ND 32 to ND 80
Hysteresis:	Approximately 0.5 bar
Connections (ND 32 to ND 50):	PVC unions or PVC spigot ends
Connections (ND 65 & ND 80):	Inlet: PVC flange; Outlet: PVC spigot ends
Flow rate limit:	3 m/s as a maximum

Operating conditions: pressure vs. temperature

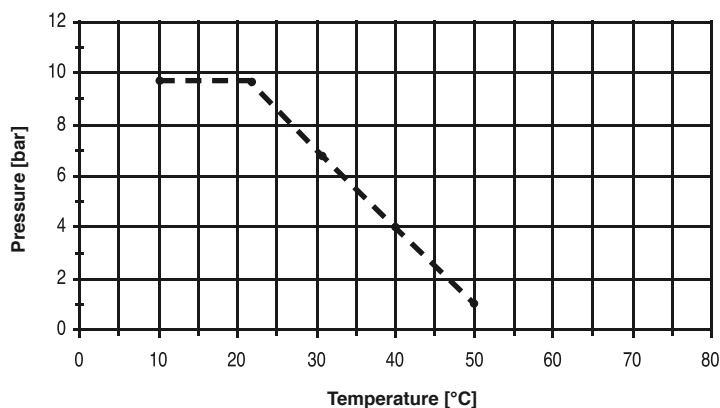

BAMO MESURES

22, Rue de la Voie des Bans - Z.I. de la Gare - 95100 ARGENTEUIL

Tél : (+33) 01 30 25 83 20 - Web : www.bamo.fr

Fax : (+33) 01 34 10 16 05 - E-mail : info@bamo.fr

Pressure relief valves
SDD 912

19-12-2011

912 I1 02 B

PLAS

912-02/1

912

CODES NUMBERS AND REFERENCES

SDD 912 with spigot ends

ND	Sealing EPDM	Sealing FPM
ND 32	912 001	912 011
ND 40	912 002	912 012
ND 50	912 003	912 013

SDD 912 with unions

ND	Sealing EPDM	Sealing FPM
ND 32	912 101	912 111
ND 40	912 102	912 112
ND 50	912 103	912 113

SDD 912, inlet: PVC flange, spigot end on outlet

DN	Joints EPDM
DN 65	912 004
DN 80	912 005

DIMENSIONS

ND	D [mm]	A [mm]	H [mm]	H1 [mm]	L [mm]	H2 [mm]	L1 [mm]	Mass [Kg]
ND 32	40	80	305* – 335	88* – 105	80* – 105	75	75	-
ND 40	50	80	341* – 360	110* – 125	95* – 120	90	85	-
ND 50	63	94	395* – 410	127* – 145	115* – 140	105	100	-
ND 65	75	150	605	202	155	-	-	-
ND 80	90	150	605	202	170	-	-	10

*: Spigot ends

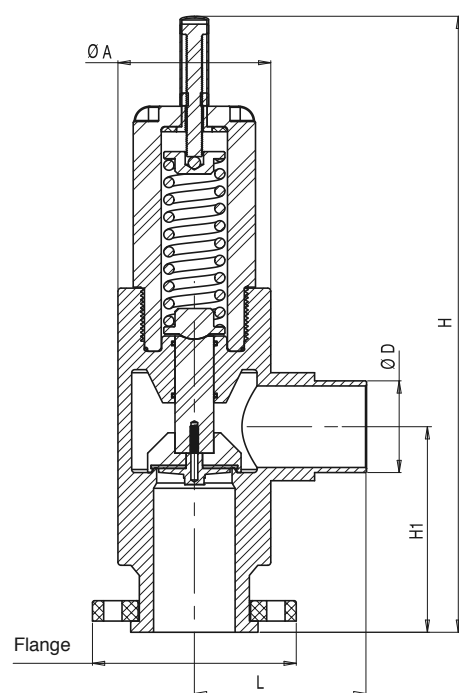

ND 65 & ND 80

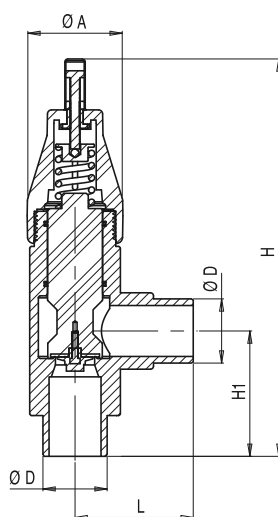

DN 32 ... 50 - spigot ends

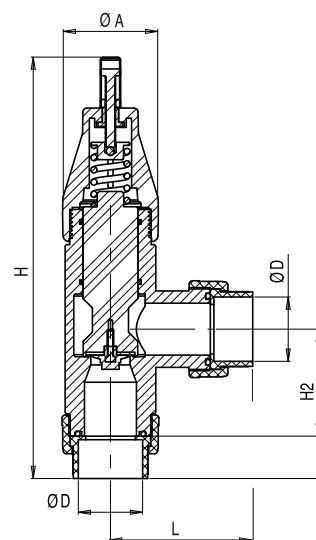

ND 32 ... ND 50 unions

BAMO MESURES

22, Rue de la Voie des Bans - Z.I. de la Gare - 95100 ARGENTEUIL

Tél : (+33) 01 30 25 83 20 - Web : www.bamo.fr

Fax : (+33) 01 34 10 16 05 - E-mail : info@bamo.fr

Pressure relief valves
SDD 912

19-12-2011

912 I1 02 B

PLAS

912-02/2